

Installationsanleitung RMS45, Stecker

Installation guide RMS45, plug

Instructions de montage RMS45, fiche

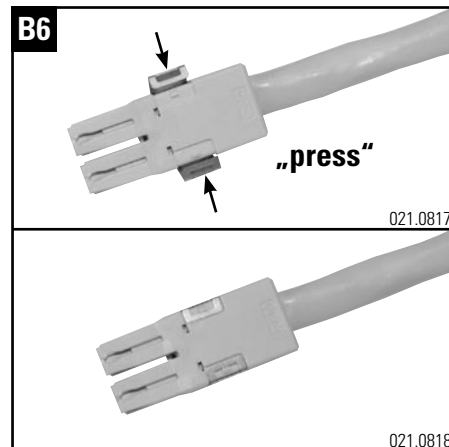
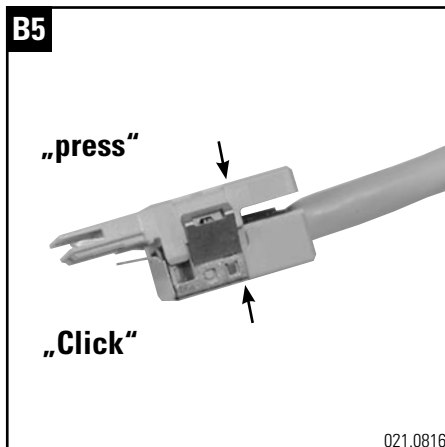
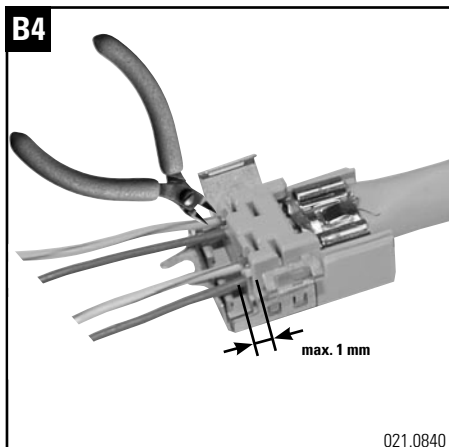
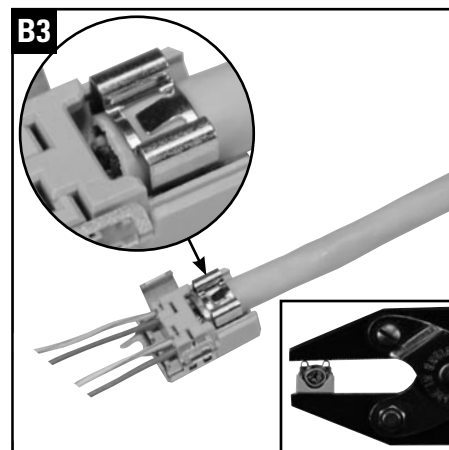
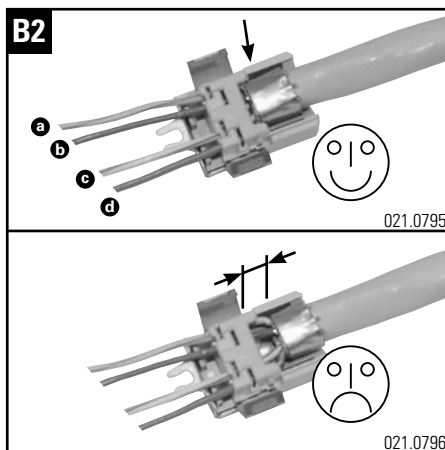
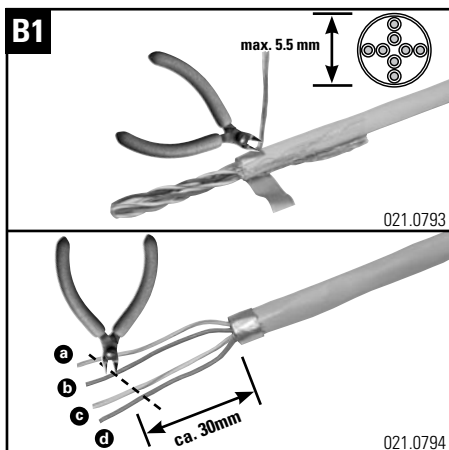
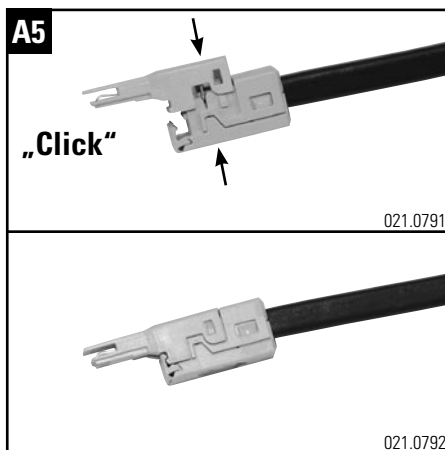
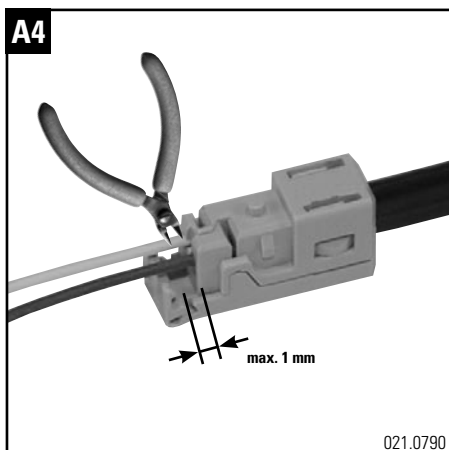
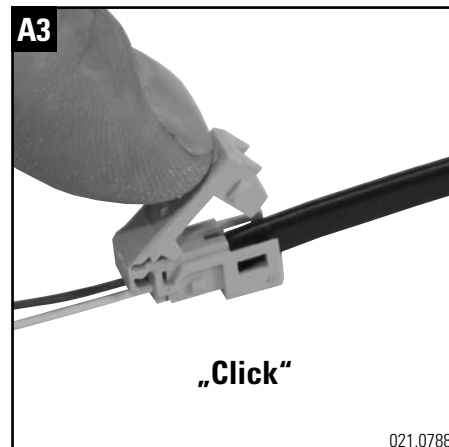
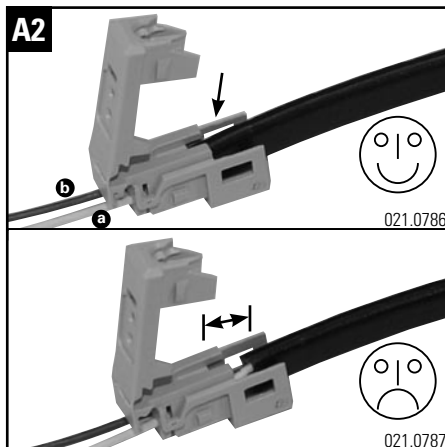
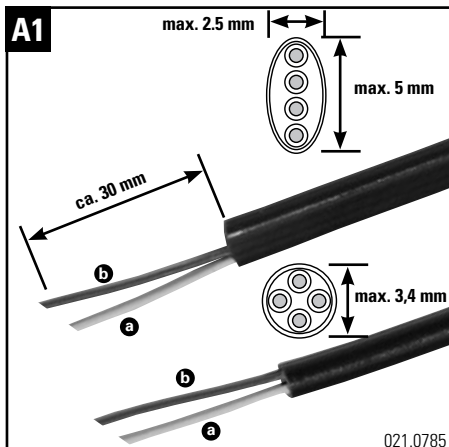
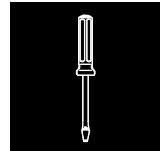

Installationsanleitung RMS45, Einsatz

Installation guide RMS45, insert

Instructions de montage RMS45, intérieur

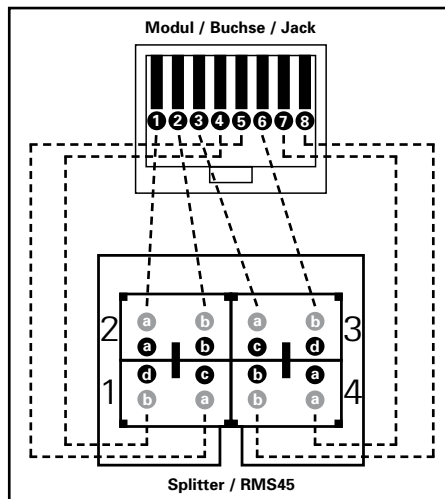
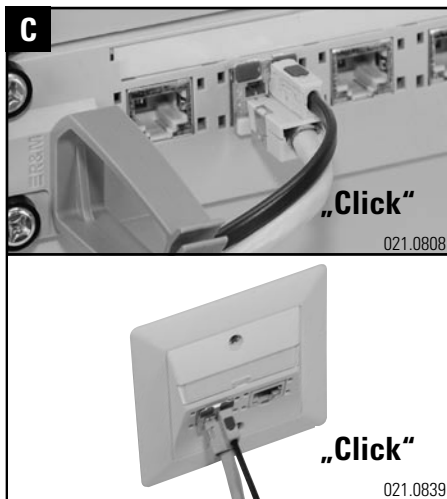
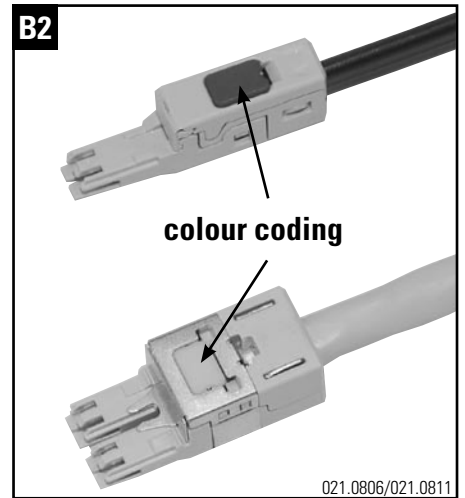
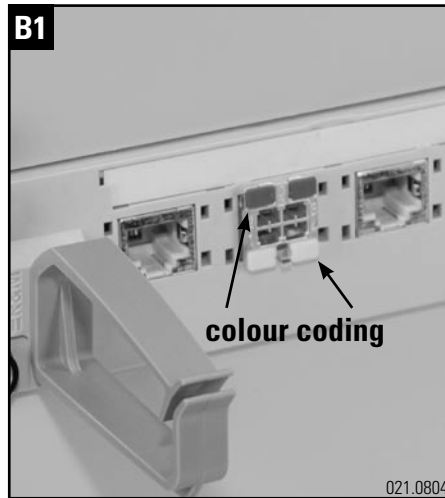
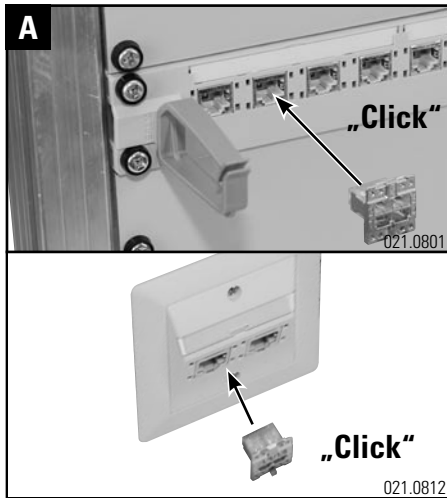
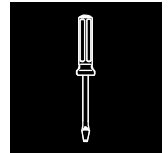

Modul / Buchse / Jack	kompatibel compatible
R&M Cat.5e Freenet	✓
R&M Cat.6 Freenet	✓
R&M Voice Panel	—
R&M Swissline	—
nicht R&M not R&M	nicht getestet not tested

Technische Daten: RMS45 1-paar

Telefon-Flachkabel:	2,5 x 5 mm
Rundkabel Ø:	3,4 mm
Rangierdraht:	2 x 0,5 mm
Draht und Litze:	AWG26 - 24
Ader-Isolation max. Ø:	1,1 mm

Technische Daten: RMS45 2-paar

Rundkabel Ø:	3,2 mm - 5,5 mm
Draht und Litze:	AWG26 - 24
Ader-Isolation max. Ø:	1,1 mm

Technical Data: RMS45 1-pair

Telephone flat cable:	2,5 x 5 mm
round cable Ø:	3,4 mm
patch wire:	2 x 0,5 mm
wire and flex wire:	AWG26 - 24
wire insulation max. Ø:	1,1 mm

Technical Data: RMS45 2-pair

round cable Ø:	3,2 mm - 5,5 mm
wire and flex wire:	AWG26 - 24
wire insulation max. Ø:	1,1 mm

⚠ Kleinteile könnten von Kleinkindern verschluckt werden
 Small parts could be swallowed by infant
 Les petites parties pourraient être avalées par les bébés ⚠

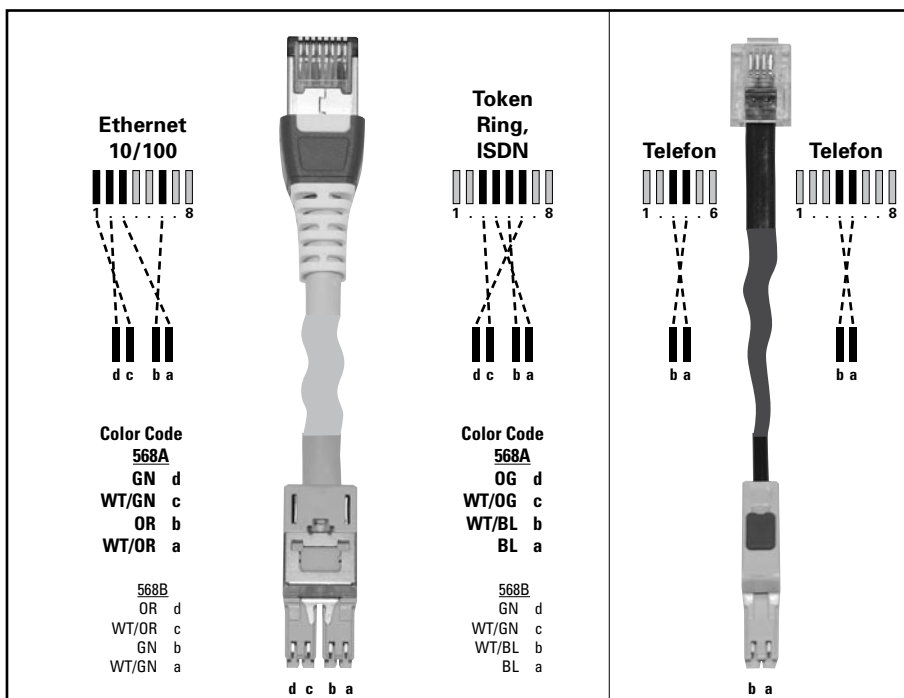

Headquarters

Switzerland

Reichle & De-Massari AG

Binzstrasse 31

CHE-8620 Wetzikon

Telephone HQ +41 (0)44 933 81 11

Telefax HQ +41 (0)44 930 49 41

E-Mail hq@rdm.com

www.rdm.com

